

Installation instructions for the Louvre Acoustic interior wall panels

Required for the installation

- Battery-powered drill
- Tape measure
- Spirit level
- Pen for markings
- 4-8 pcs drywall screws
- (Adhesive suitable for the installation)

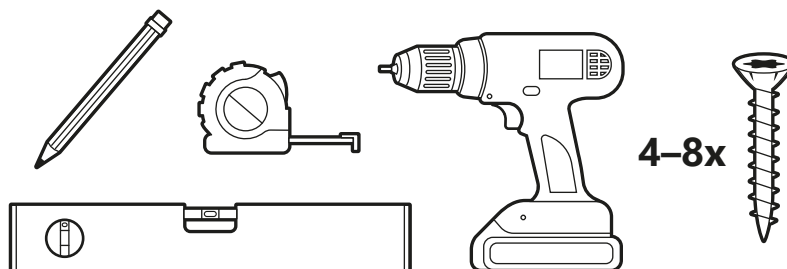

Installation

Using the tape measure, mark out the desired installation height and location.

Take into account the locations of the mounting screws. We recommend using 4-8 screws placed at the corners of the interior wall panel and closer to its middle point (see example picture).

Installation can also be carried out using an adhesive. Make sure the installation surface is suitable for adhesive installation. Use an appropriate, high-quality adhesive for the installation and apply it evenly across the entire surface area of the interior wall panel.

Note! If you are installing the interior wall panels on a plaster wall, first install appropriate screw anchors for the mounting points of the screws.

Before attaching the panel to the wall, use a spirit level to make sure that it is straight.

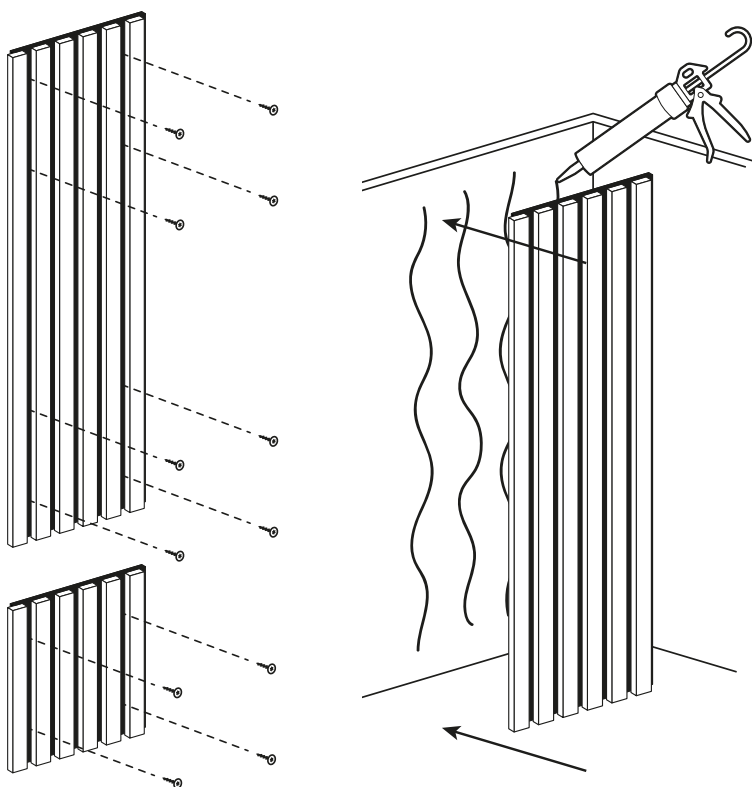

The Louvre Acoustic interior wall panels are designed to merge together to create a continuous, even wall surface of battens. Place a new panel on the tongue and groove at the edge of the previous panel.

